

# ORCHARD OF RECONCILIATION - MEMORIAL OF PRISONERS | Litoměřice, Czech Republic

CONCEPT: 3 microclimatic systems crossed by 1 line



underground pillared hall



entrance C/D



crematorium



filter station



EXISTING SITUATION

UNDERGROUND:  
former limestone mine (1947 - 1963)

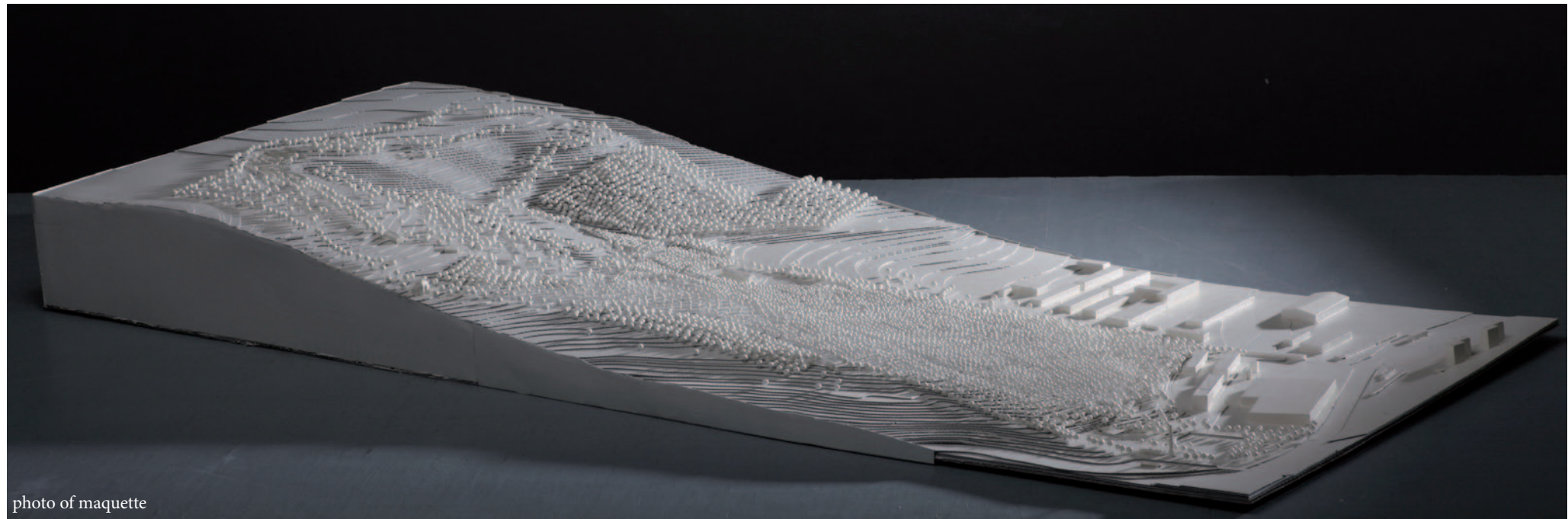
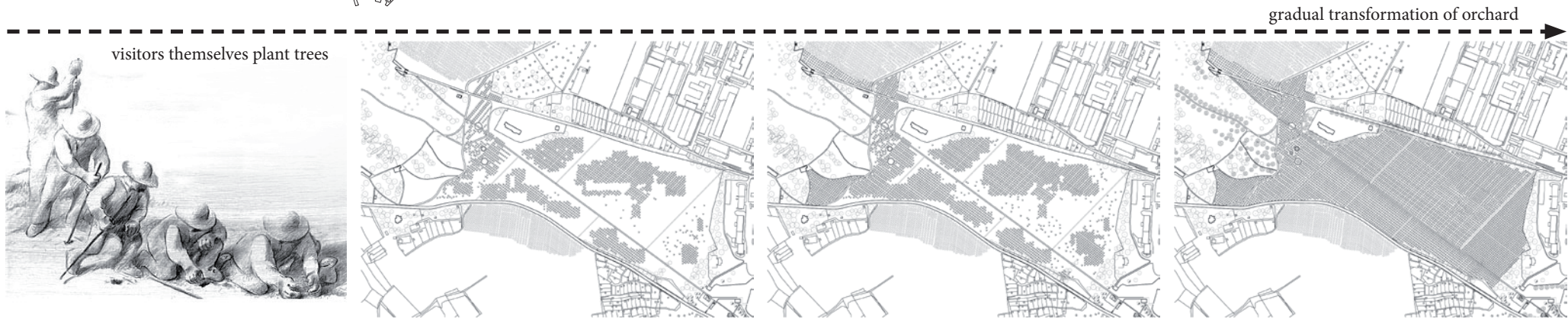
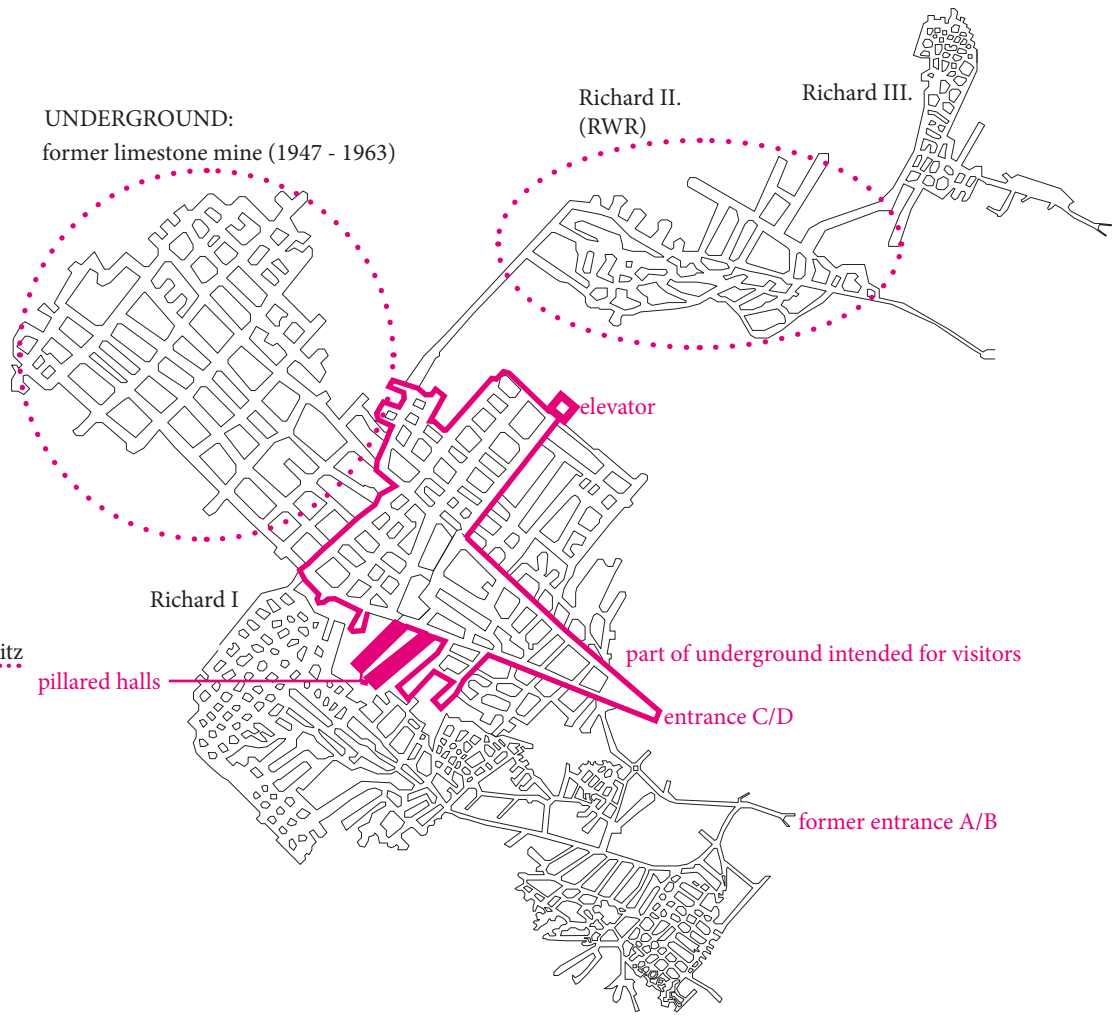
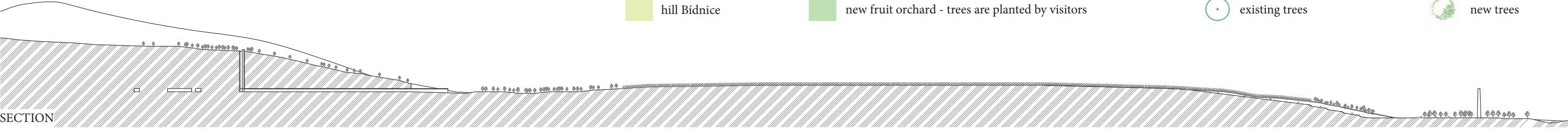

photo of maquette





*Memory is slavery, nonexistent memory is death alive (architect Matěj Páral)*

Diploma project engages the solution of location with size of 1,5 x 1 km west from Litomerice city, where is the former Nazi underground factory Richard and the crematorium. The objective of diploma thesis is development of some objects for an exhibition about history of the factory and the near concentration camp, reconstruction of some parts of underground spaces and landscape adjustment with accent on piety of whole site.

3 kilometers next to Litomerice is very famous Terezín memorial - former Nazi concentration camp - but only few people know about Litomerice city in context of Second World War. The concept is based on utilization of underground space structures of limestone-mine which was adapted for Nazi secret factory in 1944. In parallel is developed concept of new landscape. Both these mediums are joined functionally, spatially and symbolically. The permanent duality between space and its mental charge creates the main scenography of this project. Each element of organization of landscape (including water) has a symbolic meaning. The project uses contrast between organic forms of underground labyrinth and geometric grid of fruit orchard, between concrete fragments of buildings and mildness of cultural nature. The mutual neutralization of these tensions is making a complex which reconciles relationship between landscape and its history. The fragments of industrial objects (ventilation shafts, water tanks, filter station, transformers etc.) are revealed and transformed to the new context. The recovery of traumatic memory is symbolized by ritual acts of visitors who will themselves plant the apple trees into the new orchard. The experience of free move is in a paradox to history. The landscape is slowly - step by step changing and recovering. Its potential is highlighted, the monumentality of underground spaces is showed on surface. The site consists of 3 different microclimatic systems: area of former crematorium, grassed territory without any meaning and limestone hill „Bídnice“. All the microclimates are crossed by one line („groove“) leading from crematorium to underground entrance C/D. This line is visually fixed at chimney of crematorium. Functionally the project uses the climatic and topographic conditions. The project is full of symbolism. It is not didactic or tourist attraction. It is going on personal intention of each pilgrim who will discover the historic context. It is attempting to formulate new reinterpretation of all elements in the landscape. Garden of Bohemia is changing into Orchard of Reconciliation.







AREA OF CREMATORIUM | SITUATION 1:750

- 1 | parking (7 x bus, 107 x car)
- 2 | imprint of floorplan of former house of cremator Wenzel Pritzl
- 3 | former crematorium
- 4 | chimney
- 5 | visitor center, museum exhibition about history
- 6 | staff entrance
- 7 | „groove“ - the path from crematorium to entrance C/D
- 8 | existing object will be used as a storage and garden service
- 9 | new footbridge connecting crematorium and cemetery

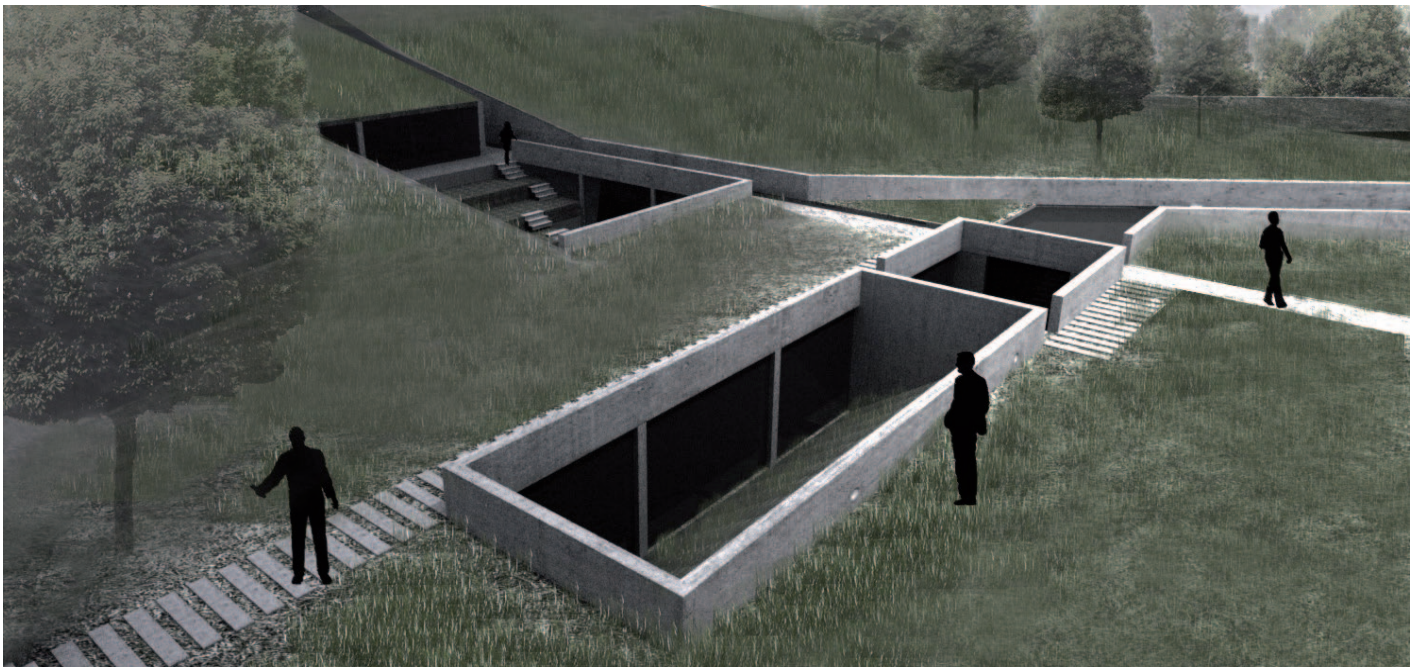

visitor center



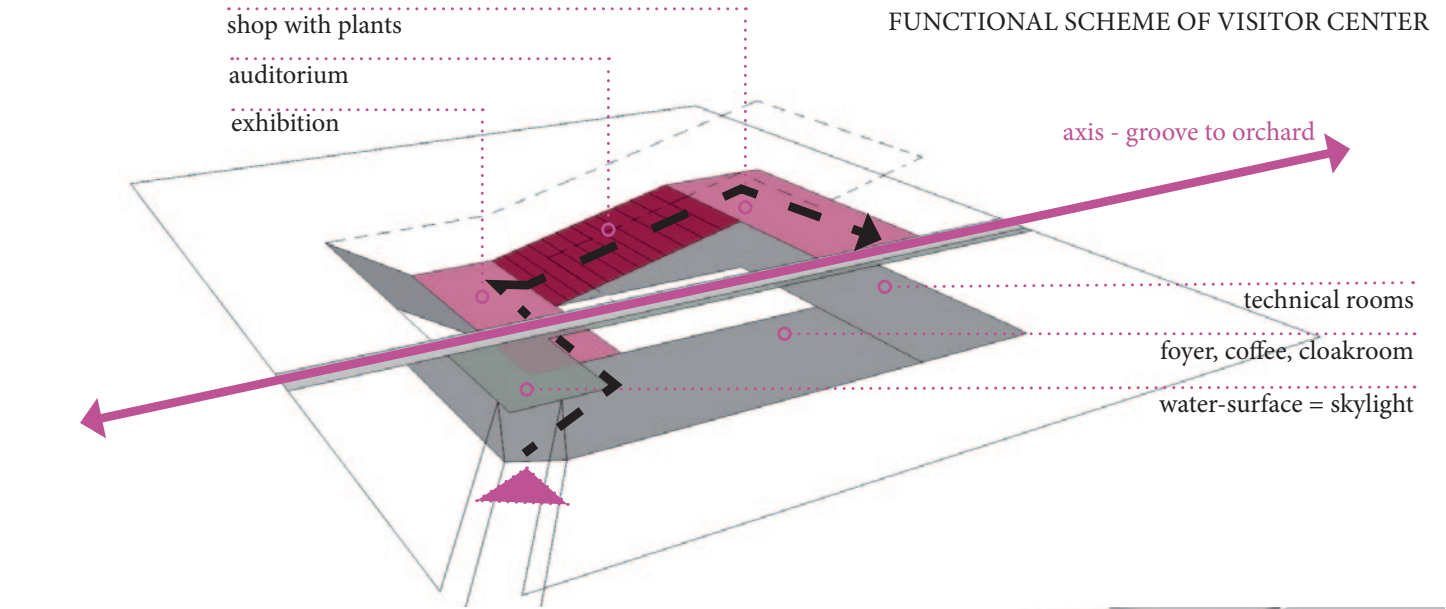
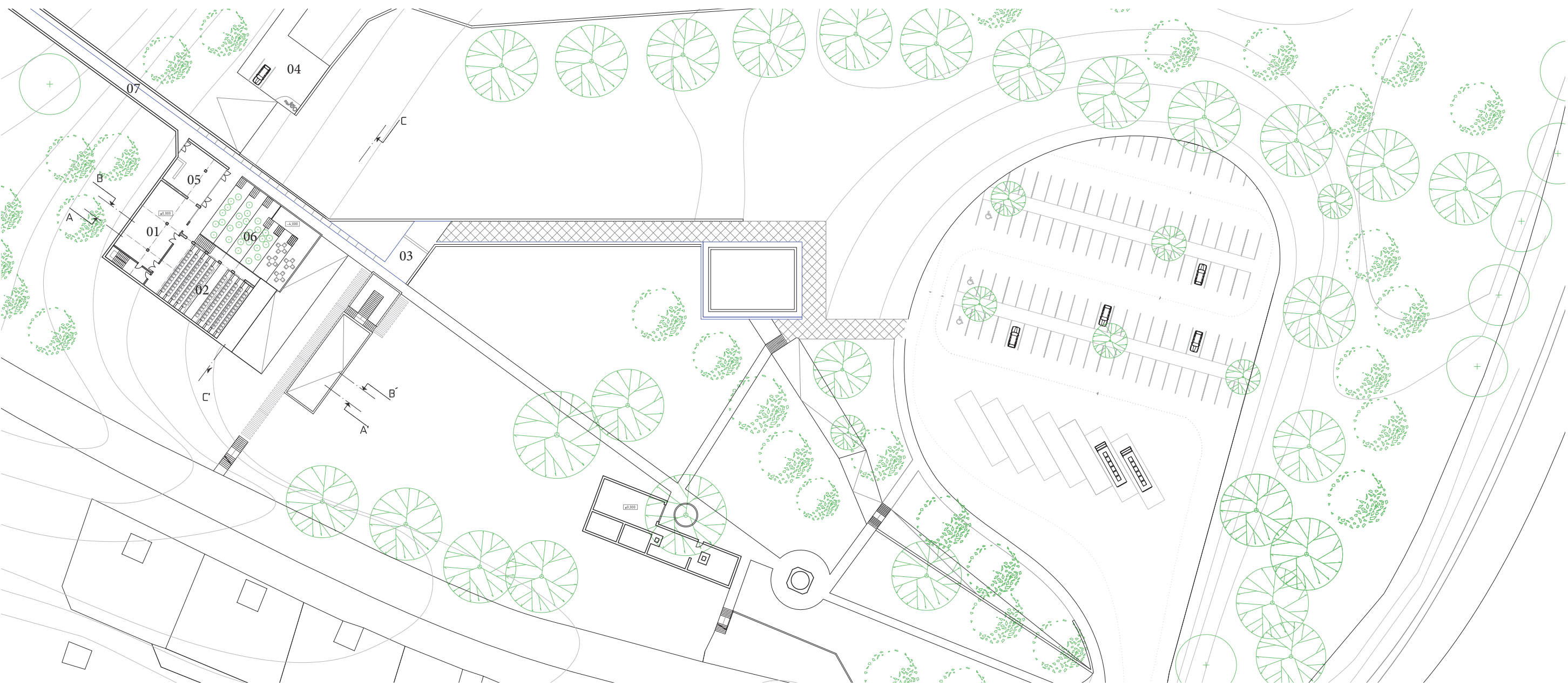

- 1ST FLOOR
- 01 | exhibition
  - 02 | auditorium
  - 03 | water surface = skylight
  - 04 | staff parking
  - 05 | plants store
  - 06 | atrium
  - 07 | „groove“
- BASEMENT
- 01 | foyer, reception desk, book store
  - 02 | café | 170 m2
  - 03 | exhibition area
  - 04 | auditorium
  - 05 | technical room
  - 06 | storage, depository
  - 07 | staff, office

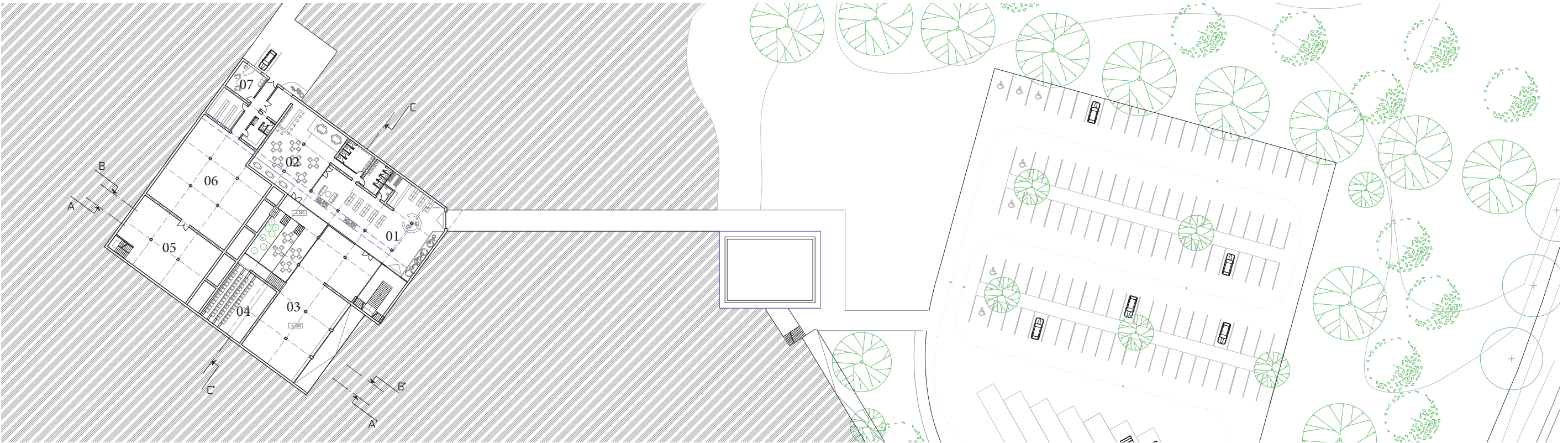
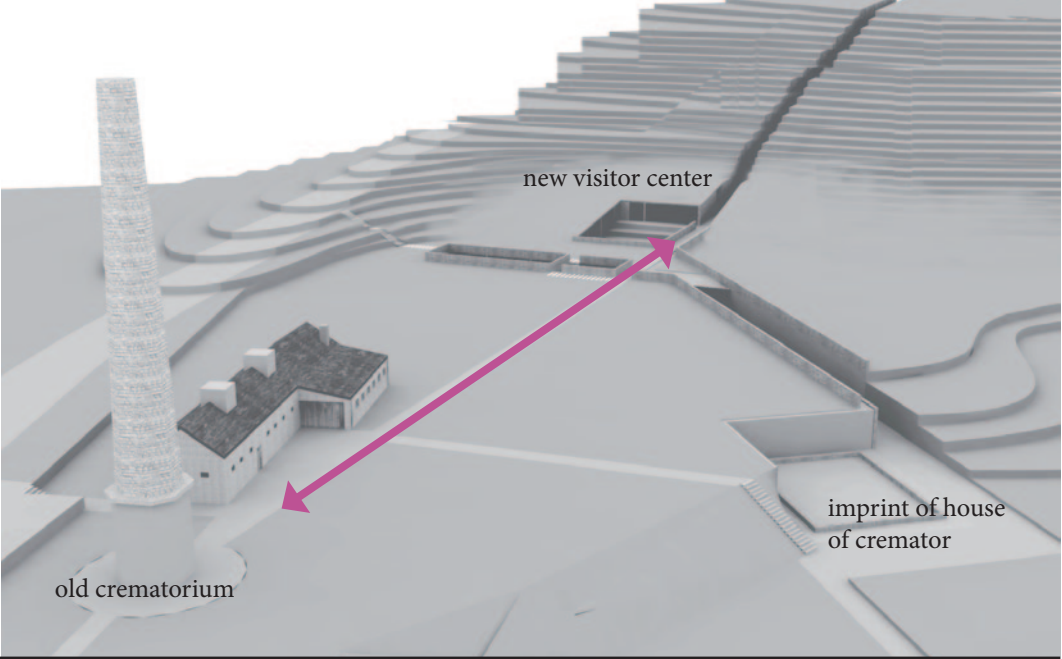





visitor center | crematorium

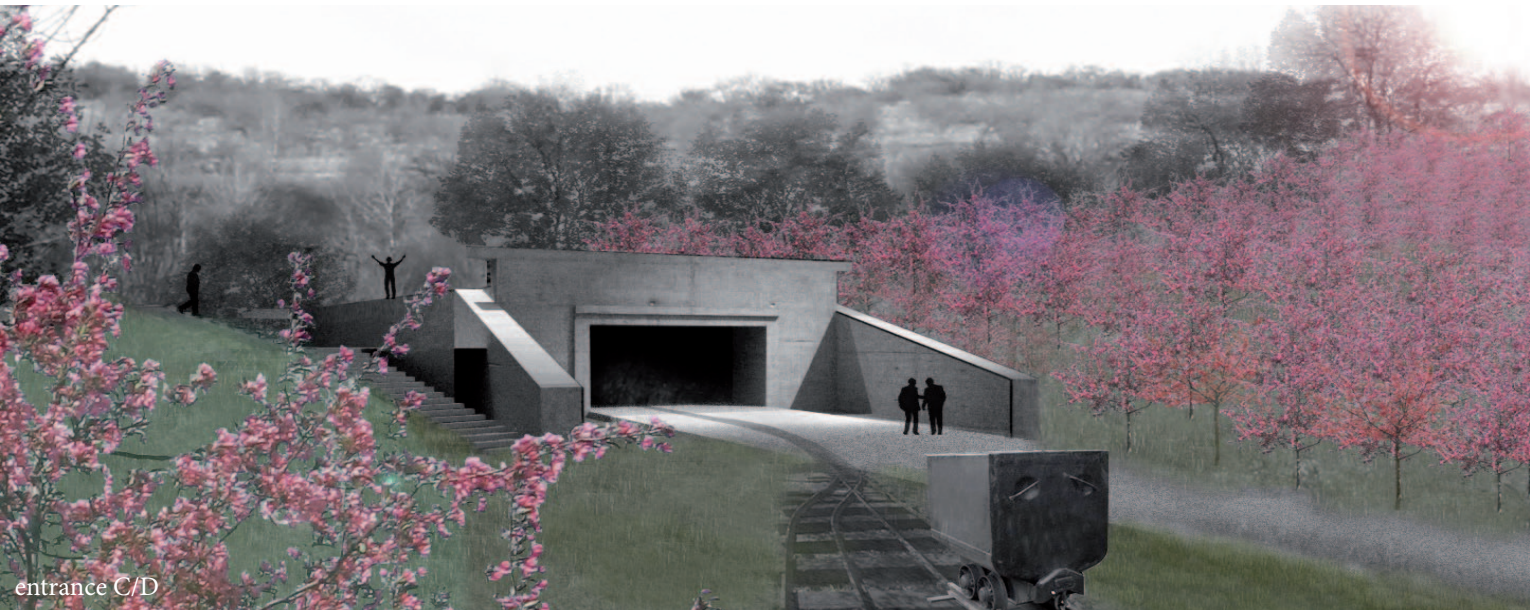

entrance C/D



filter station

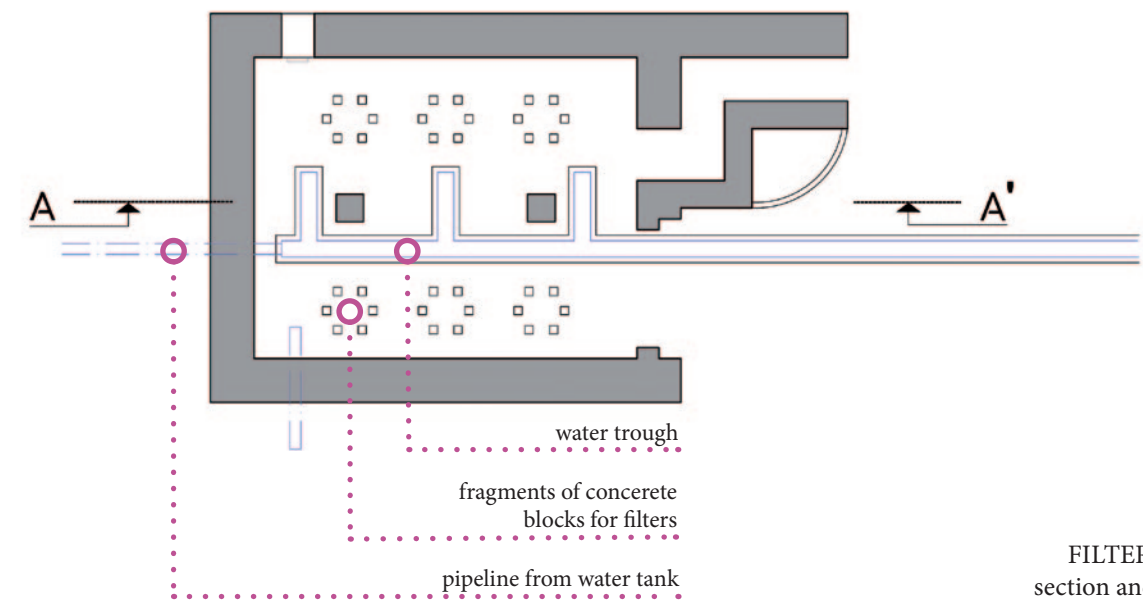
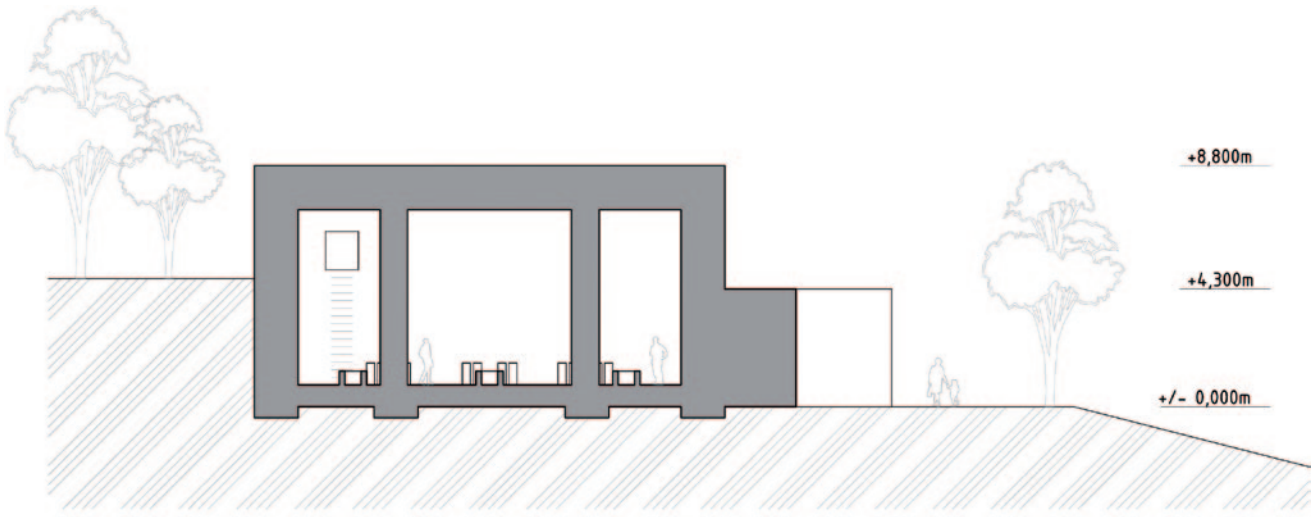

FILTER STATION  
section and floor plan



main underground corridor



elevator



pillared hall



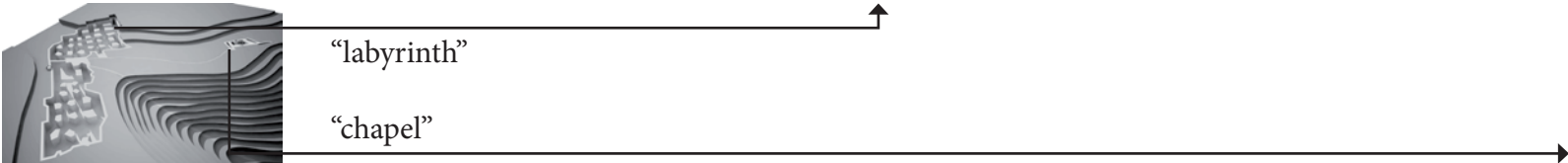
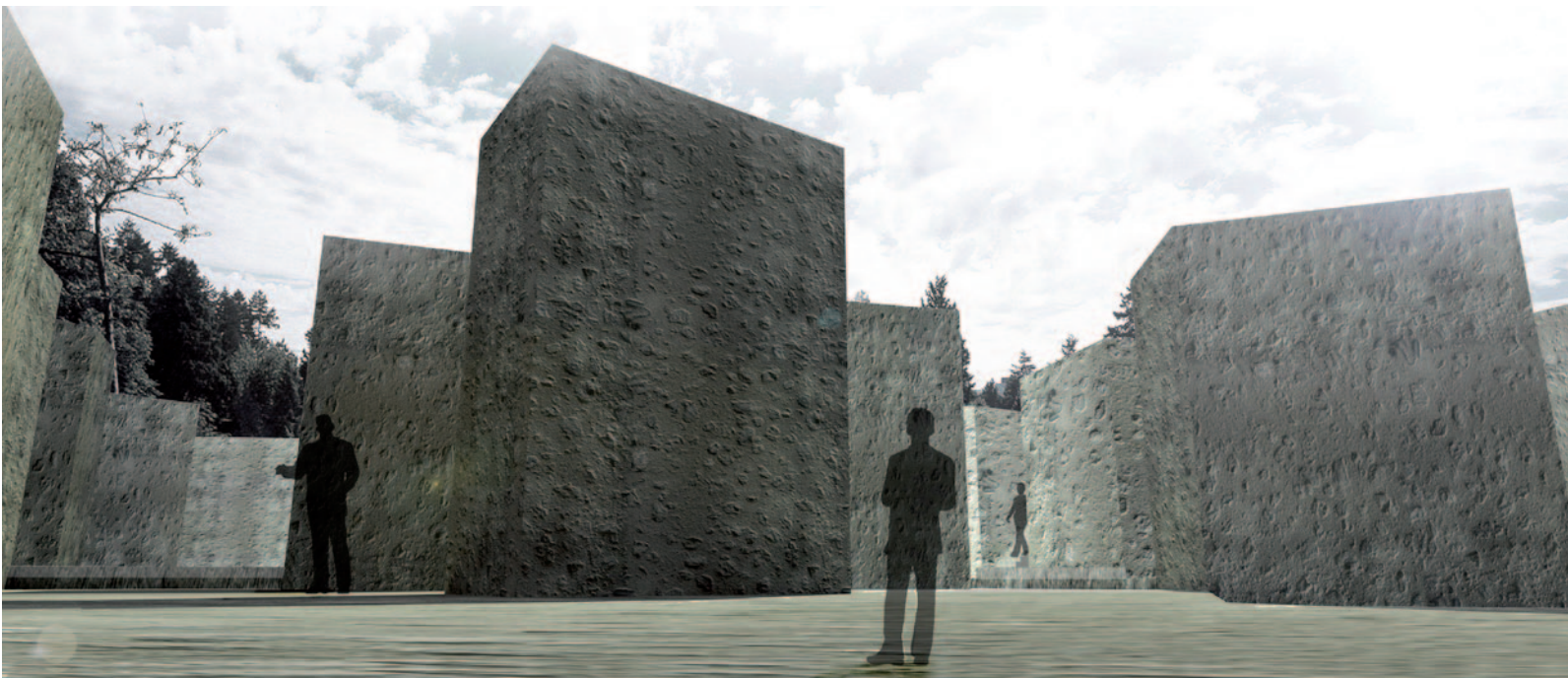

panoramic view from chapel on Litoměřice and Czech Central Mountains

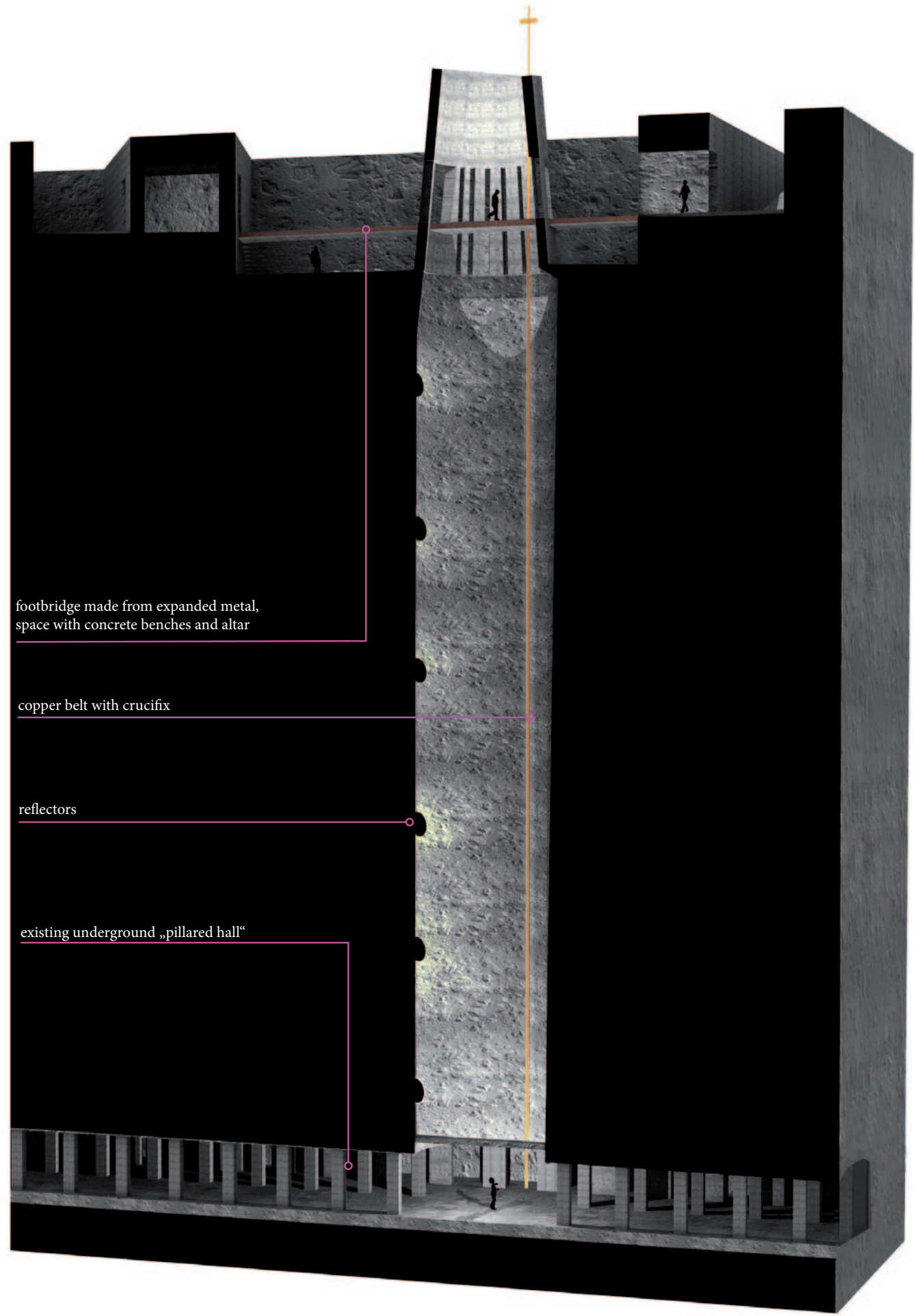

SECTION OF CHAPEL - FORMER VENTILATION SHAFT